

cinch
STADIUM

FRANKLIN'S
GARDENS

- Meetings • Conferences
- Dinners & Parties • Exhibitions
- Weddings • Team Building



CINCH STADIUM AT FRANKLIN’S GARDENS

Located in the heart of England, Franklin’s Gardens – home of Northampton Saints – can also be at the heart of your perfect event.

Just an hour away from London, Birmingham, Oxford and Cambridge, five minutes from the M1 and within easy reach of a number of major airports, Franklin’s Gardens is the ideal location for your event no matter where your guests are coming from.

Franklin’s Gardens has everything you would expect from a modern conference, event and party venue; from a portfolio of beautifully appointed suites, offering a stylish and comfortable setting for any event, to complimentary Wi-Fi to bars and in-house catering, not to mention over 1,500 on-site car parking spaces available.

And with it also being home to Premiership Rugby team Northampton Saints, a selection of the spaces offer a glazed front with outstanding views of the famous Franklin’s Gardens stadium creating a memorable backdrop and talking point for your conference guests and delegates.

If you’re planning an event, we’d love to hear about your ideas.

Call us today on 01604 599 136 or email franklingardens@northamptonsaints.co.uk



WHERE GREAT EVENTS HAPPEN

- 11 function rooms across the venue
 - Opportunity for tailor-made packages to suit the needs of your group
 - Exclusive private hire
 - Facilities to accommodate up to 1,000 people
 - 1,500 free on-site car parking spaces
- Complimentary Wi-Fi across the site
 - Dedicated Events Team
 - AV, bespoke staging and enhanced branding opportunities available
 - Opportunities to have Northampton Saints silverware at your event



DIRECTORS

Located on the first floor of the Carlsberg Stand, the Directors Lounge offers a distinguished space for any occasion. This beautifully furnished lounge has its own private bar, dedicated registration desk and can hold up to 120 delegates. Two boardrooms and 1880 Suite are also available as part of a wider package.

Boardroom

The Directors Lounge boardroom is fitted with the latest AV equipment and a private refreshment station and can hold up to 16 delegates, making it perfect for small business meetings.

Small Boardroom

This intimate space can hold up to five delegates and includes its own private refreshment station.

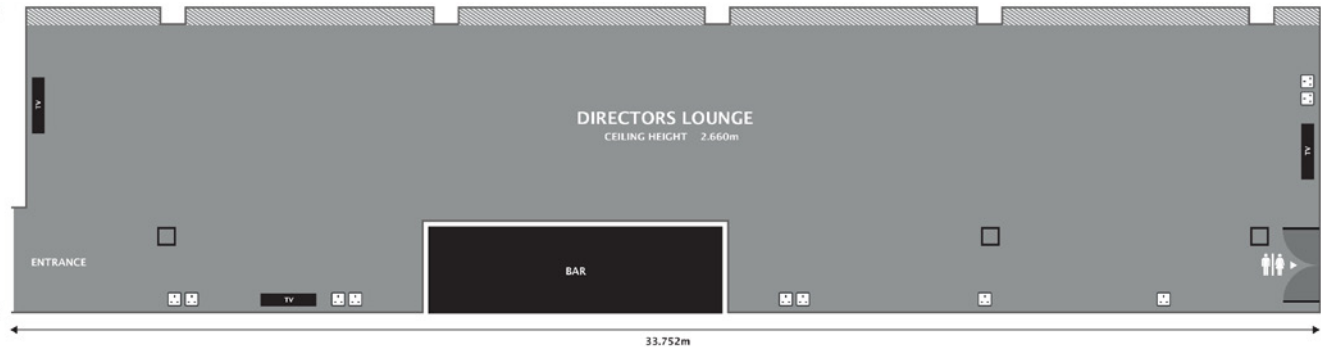

1880 SUITE

Our spacious 1880 Suite, located on the first floor of the Carlsberg Stand, is designed to provide a relaxing space for hosting meetings or any small events. This light and airy room is fitted with the latest AV equipment and a private refreshment station.

Layout	Capacity
Theatre	50
Boardroom	26
Classroom	26
U-Shape	16
Cabaret	32
Buffet w/tables	40
Buffet	40

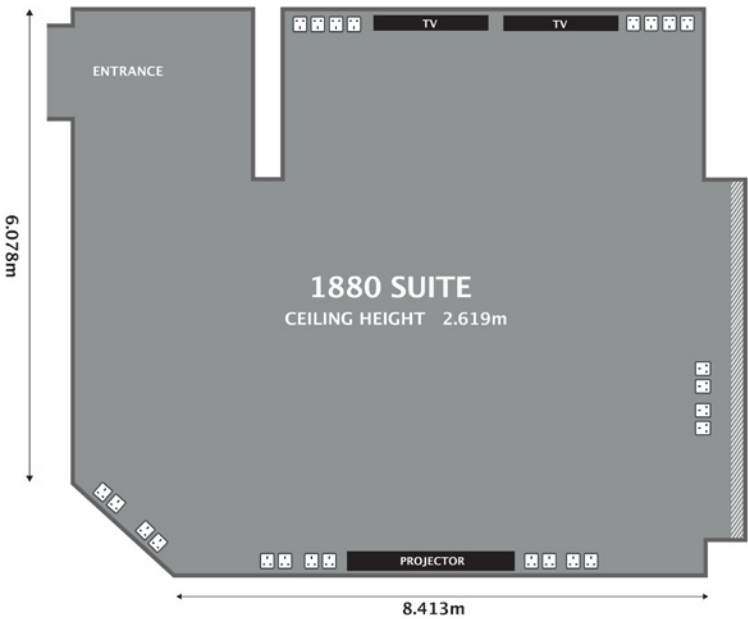



EXECUTIVE BOXES

Franklin's Gardens' range of Executive Boxes all offer a stunning view of the pitch and are ideal for meetings and lunches.

Single

Our single boxes offer first-class amenities for up to 15 delegates and are perfect for small business meetings.

Layout	Capacity
Boardroom	12
Buffet	15

Double

Our double-sized Executive Boxes all have spectacular views of the pitch and are designed to hold up to 30 people in either a formal or relaxed setting.

Layout	Capacity
Theatre	24
Boardroom	16
Buffet	30

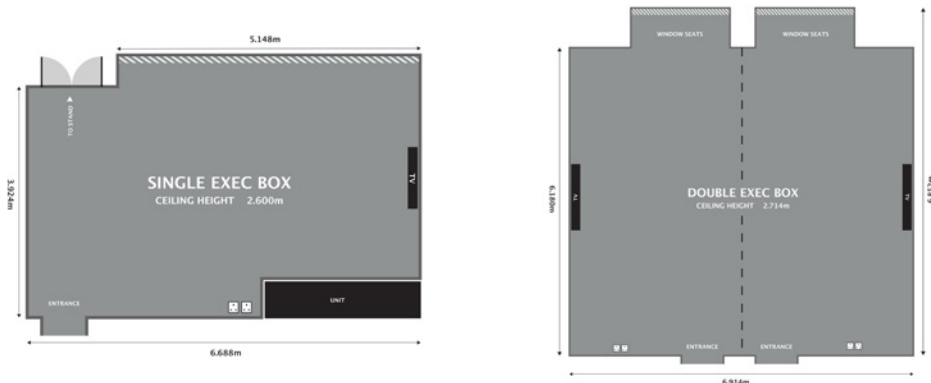

CARLSBERG LOUNGE

The Carlsberg Lounge is a unique and flexible space for up to 40 delegates to be entertained in a more relaxed way. As you'd expect, it boasts its own private bar and has magnificent views of the Franklin's Gardens pitch. Its informal décor and atmosphere makes it the perfect choice for networking events and smaller meetings.

Layout	Capacity
Theatre	40
Boardroom	18
Classroom	18
Cabaret	16
Buffet	40

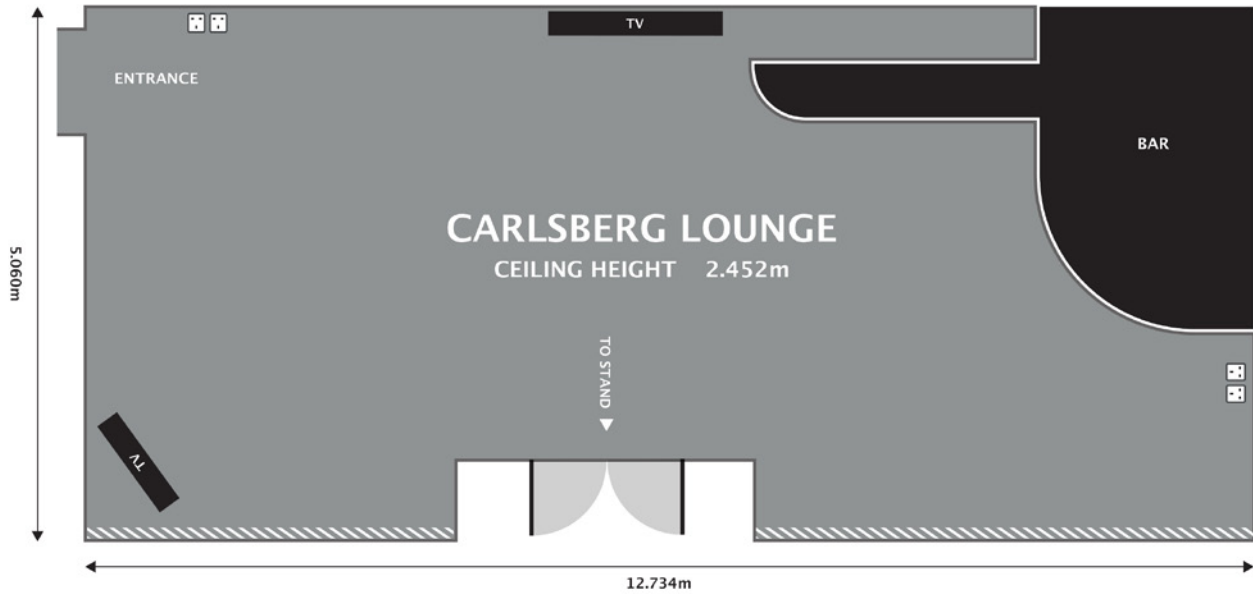



RODBER

The Rodber Bar is the largest space at Franklin’s Gardens and is able to host up to 600 delegates – making it ideal for hosting large events, conferences, exhibitions and dinners. Located on the ground floor of the Carlsberg Stand with its own reception area, it has pitch access for photos and contains a number of private bars as well as the latest AV equipment.

Layout	Capacity
Theatre	600
Classroom	120
Cabaret	250
Buffet w/tables	350
Buffet	450
Dinner/Dance	350
Dinner	400

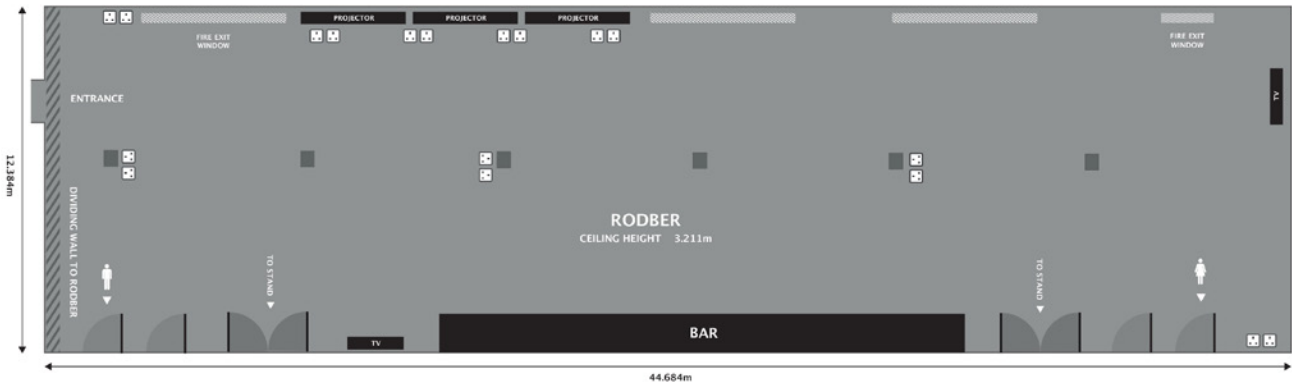

CAPTAINS

Captains is a new, fully refurbished space located on the ground floor of the Carlsberg Stand with the capacity to hold up to 150 delegates. Fitted with flat-screen TVs, the latest AV equipment and its own private bar, this space is ideal for networking events and informal meetings.

Layout	Capacity
Theatre	72
Boardroom	64
Cabaret	42
Buffet w/tables	100
Buffet	150

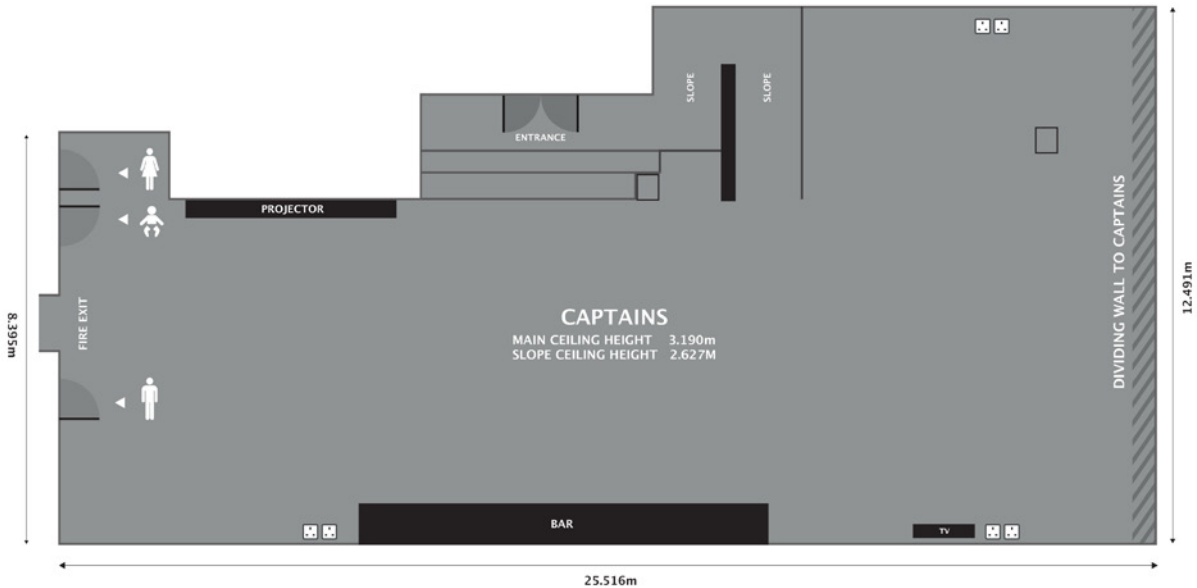



HEROES RESTAURANT

The Heroes Restaurant – located on the ground floor of the Carlsberg Stand – is an ideal setting to host lunches and dinners, corporate gatherings, product launches, conferences and meetings. It boasts a private bar and space for a dance floor, also making it an excellent venue for parties, dinners and smaller evening receptions.

Layout	Capacity
Theatre	80
Boardroom	24
Classroom	40
U-Shape	20
Cabaret	64
Buffet w/tables	120
Dinner/Dance	80
Dinner	120

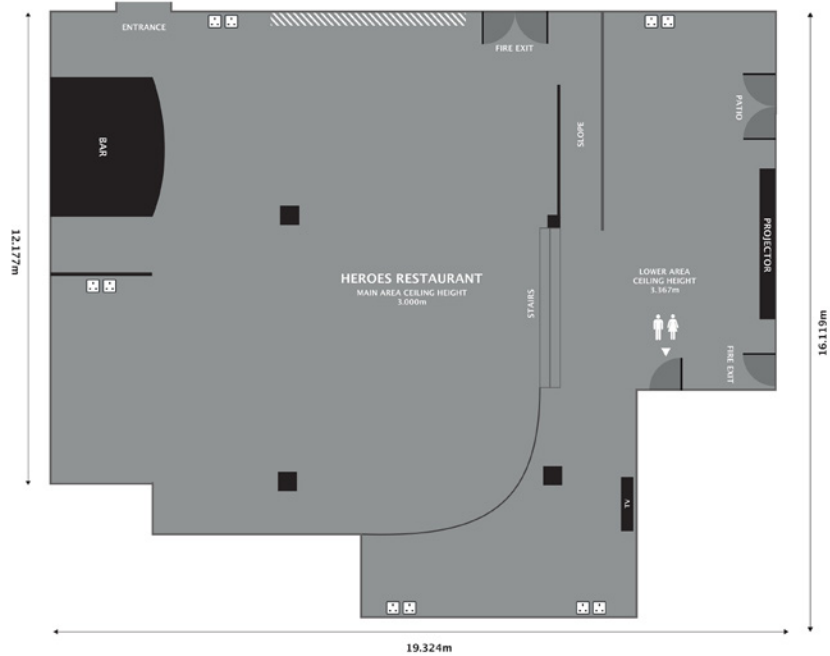

MEMBERS

Located on the ground floor of the Barwell Stand this large, informal space has its own reception area and offers flexibility to hold up to 180 people. With a private bar and the very latest AV equipment, this versatile space is suited to hosting conferences, exhibitions, large gatherings and dinners.

Layout	Capacity
Theatre	160
Boardroom	50
Classroom	60
U-Shape	30
Cabaret	150
Buffet w/tables	150
Buffet	180
Dinner/Dance	150
Dinner	180

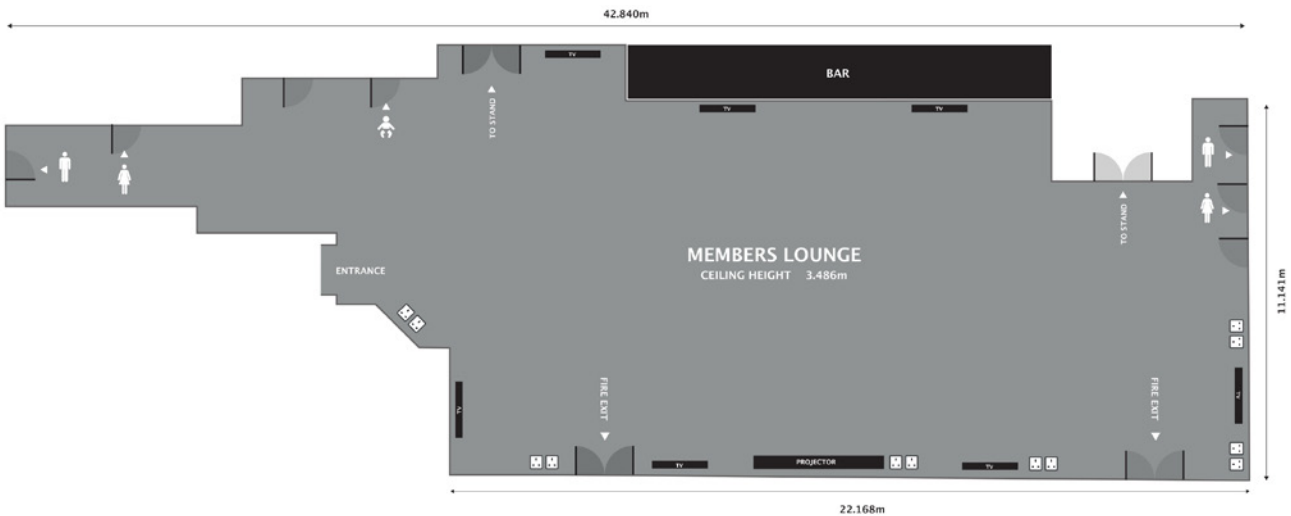



CHAMPIONS

Located on the first floor of the Barwell Stand, this modern suite has its own private bar, and is ideal for a variety of events. Its flexibility makes it a perfect choice for conferences and meetings, as well as an excellent venue for dinners and evening receptions. The space can hold up to 300 delegates, with removable partitions for smaller events, and its glazed frontage offers outstanding views of the Franklin's Gardens pitch.

Layout	Capacity
Theatre	250
Boardroom	60
Classroom	80
U-Shape	60
Cabaret	135
Buffet w/tables	180
Buffet	250
Dinner/Dance	150
Dinner	180

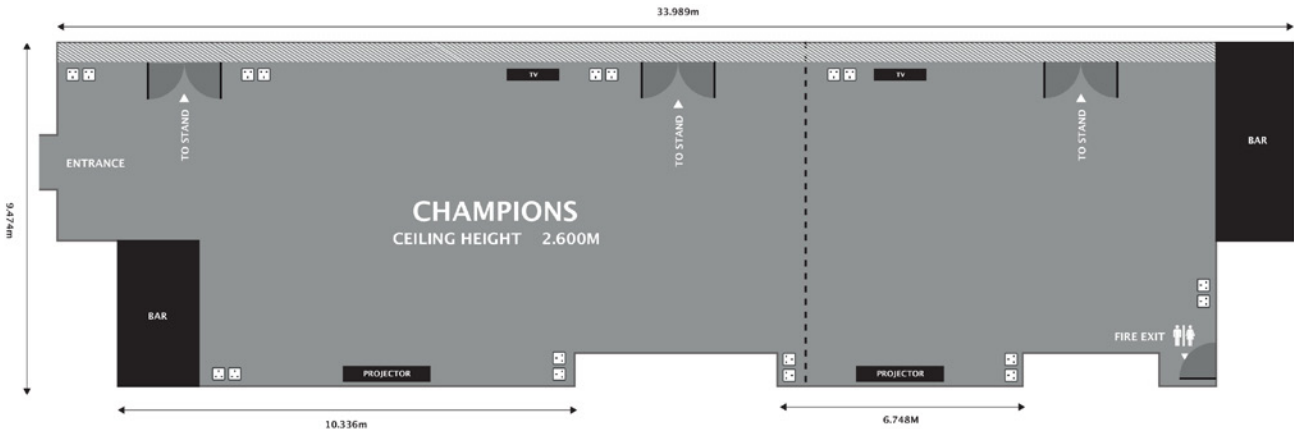

OTHER FACILITIES

In addition to our wide range of lounges, suites and restaurants, Franklin's Gardens has several other jewels in its crown that will take your conference, event or meeting to the next level.

- Village**
The Saints Supporter Village, located behind the stadium's South Stand, is a multi-functional space ideal for team-building events, outdoor exhibitions, and trade events. This flexible environment has access to a number of bars and food outlets, a big screen and stage, as well as having easy access to the training pitches and the main Franklin's Gardens pitch.
- Training Pitches**
Our training ground facilities are available to hire for both corporate events and private sports fixtures. We will create a fantastic day for you, whether you'd like us to host tournaments, festivals, charity matches, or even a game with friends and family on the training pitches. Packages include training pitch hire, access to VIP areas (including the players' changing rooms), catering options, room hire, and player appearances.

- Stadium**
With a seated capacity of 15,249 and a concert capacity of up to 18,000, our stadium bowl is an attractive option for promoters and UK governing bodies. As well as being home to Premiership Rugby club Northampton Saints, Franklin's Gardens regularly hosts other high-profile sporting events such as the Premiership Rugby Cup final, Premiership Rugby 7s, England U20s rugby fixtures, testimonials and benefit games. But the stadium is not limited to rugby events; we welcomed over 17,500 fans through the gates for Lionel Richie's 2018 'All The Hits' UK Tour, and hosted the first-ever Tough Mudder event to take place inside a sports stadium in 2019.
- We are flexible to hold other events, team-building days, mass-participation events and more – so please get in touch to discuss availability.

- Parking**
The Franklin's Gardens site has five exclusive and secure car parks (totalling 1,500 car parking spaces) which are available for private hire. Each car park has direct access to arterial roads and is within a short walk of Franklin's Gardens. We can also supply parking attendants to manage your needs.

CAPACITIES

	Theatre	Boardroom	Classroom	U-Shape	Cabaret	Buffet w/ table	Buffet	Dinner/Dance	Dinner
Directors lounge	80	36	36	38	42	80	120	-	80
Cocktail Lounge	50	26	26	16	32	40	40	-	-
Executive boxes	-	12	-	-	-	-	15	-	-
Executive Boxes (Barwell Double)	24	16	-	-	-	-	30	-	-
Carlsberg Lounge	40	18	18	-	16	-	40	-	-
Rodber	600	-	120	-	250	350	450	350	400
Captains	72	64	-	-	42	100	150	-	-
Heroes Restaurant	80	24	40	20	64	120	-	80	120
Members	160	50	60	30	150	150	180	150	180
Champions	250	60	80	60	135	180	250	150	180

SAMPLE SET MENUS

SET MENU A

Please select 1 x starter, 1 x main course plus vegetarian, 1 x dessert

Starters
Cotswold Chicken & Ham Ballotine, Pea shoot and blood Orange Grapefruit
Goats Cheese, roasted Beetroot & Thyme Tartlet (v)
Trio of Duck Pancakes, Spring Onion, Cucumber & Hoi Sin sauce
Mains
Ale braised Beef Casserole, Bubble & Squeak cake, whole roasted Vegetables
Tamworth Belly of Pork, Granny Smith Hash cake, buttered Spinach, sticky Cider Sauce
Sage and Onion stuffed Chicken Breast, Fondant Potato, Spring Greens, Roast pan Gravy
Shitake & Chestnut Mushroom Gnocchi, Rocket Leaves & Parmesan Shavings (v)
Desserts
Northampton Saints Jaffa Cake
Glazed Lemon Tart, Fruit Compote
Apple and Sultana Crumble, Creamy Custard
Freshly brewed Fairtrade tea and coffee
£27.00 + VAT per person

SET MENU B

Please select 1 x starter, 1 x main course plus vegetarian, 1 x dessert

Starters
Blue Cheese Panna Cotta, Bramley Apple & Celery, Candied Walnuts (v)
Mackerel and Caper Pate, Celeriac & Golden Beetroot Marmalade
Cotswold Chicken Caesar Salad, flaked Padano
Mains
Herb roasted fillet of Pork, Hasselback Potato, roasted Root Vegetables, served with Cider Cream sauce
Braised Beefsteak, Grain mustard Mash, Lumpy Onion Gravy
Baked Paneer Cheese & Coriander Tart, wilted Red Chard, Bombay Potato Salad (v)
Roast Cornish Cod, Spring Greens, crispy Chicken Skin, smoked Roe, Caviar Sauce
Desserts
Rich Chocolate truffle Torte, Blood Orange Sorbet
Baked Vanilla Cheesecake, Summer Berry Fruits
Baked Fruit Scone, Clotted Cream, Sloe Gin Roasted Strawberries
Potted Chocolate Brownie, Chocolate Sauce
Freshly brewed Fairtrade tea and coffee
£30.00 + VAT per person

SET MENU C

Please select 1 x starter, 1 x main course plus vegetarian, 1 x dessert

Starters
Poached, Smoked & Beetroot cured Salmon, Soused Cucumber, Dill Oil
Smoked Duck, marinated Carrot, red Onion Marmalade, Brioche Crumb
Confit of Pork & Caramelized Apple, Mixed Leaf herb dressing
Herb Polenta Cake, Wild Mushroom Ragout, Coriander Oil (v)
Mains
Fillet of Seabass, Crushed New Potato, blistered Sweet Cherry Tomato, braised Fennel
Confit of Duck leg & Breast, braised Red Cabbage, Dauphinoise Potato
Butternut Squash & Hazelnut Cannelloni, Spinach & Leek Sauce
Rump of Lamb, Confit of shoulder Bon Bon, buttered Kale, Carrot ingot, Fondant Potato, Roasted Lamb Jus
Roasted Rack of Pork, Garlic & Thyme Mash and Pot roasted root Vegetables
Desserts
Vanilla and White Chocolate crème Brule
Black Forrest Gateaux
Warm Treacle Flan, Honeycomb Ice cream
Dark Chocolate Tart, salted Caramel Sauce, Clotted Cream
Dry Martini Posset, Fresh Raspberries and Shortbread Biscuit
Freshly brewed Fairtrade tea and coffee
£35.50 + VAT per person

SAMPLE BUFFET MENUS

FINGER BUFFET

Please select one menu

- Selection of Hand cut Meat and Vegetarian Sandwiches Chicken and Basil Kebab
- Roasted Tomato and Brie Tarts
- Handmade Sausage Rolls
- Hand Cut Tortilla and Dips
- Chef's choice of Dessert
- £16.50 + VAT per person

- Selection of Hand cut Meat and Vegetarian Sandwiches
- Chicken and Basil Kebab
- Roasted Tomato and Brie Tarts
- Hand cut Tortilla and Dips
- Handmade Sausage Rolls
- Courgette and Butternut Squash Kebabs
- Mini Burgers, Mustard and Ketchup
- Chef's choice of Dessert
- £18.50 + VAT per person

- Selection of hand cut Meat and Vegetarian Sandwiches and Wraps
- Chicken and Basil Kebab
- Roasted Tomato and Brie Tart
- Hand cut Tortilla and Dips
- Mini Burgers, Mustard and Ketchup
- Bite-size Sausage and Mash
- Courgette and Butternut Squash Kebabs
- Handmade Sausage Rolls
- Chef's choice of Dessert
- £20.50 + VAT per person

WORKING BUFFET

- Selection of Hand Cut of Meat and Vegetarian Sandwiches
- Hand Cut Tortilla and Dips
- Fruit Basket
- £11.50 + VAT per person

FORK BUFFET

Please choose 2 Mains

- Traditional Cottage Pie
- Chicken & Wild Mushroom Fricassee, White wine Tarragon
- Classic Beef Lasagne, Garlic Bread Slice
- Steak and Ale Pie, Fluffy Puff Pastry
- Spicy Chicken and Peppers, Black Bean Sauce

Please choose 1 Vegetarian option

- Spiced Butterbean and Mediterranean Vegetable Casserole
- Tarragon and Wild Mushroom and Gnocchi
- Chickpea and Spinach Curry
- Chargrilled Vegetable Lasagne

Please choose 2 side dishes

- Honey-glazed roasted Root Vegetables
- Buttered New Potatoes
- Steamed Herb Rice or Egg Fried Rice
- Creamed Mash Potatoes
- Thyme and Garlic Roasted Potato

Please choose 2 salad options

- Herbed mixed Green Leaf, Parmesan Croutons
- Roasted Mediterranean Vegetable Pasta
- Crunchy Red Onion Coleslaw
- Chive New Potato Salad
- Chunky Tomato and Torn Basil

Please choose 1 Dessert option

- Cookies and Cream Cheesecake
- Rich Chocolate Brownie, Vanilla Cream
- Apple and Sultana Crumble, Crème Anglaise
- Fresh Fruit Salad
- Chocolate and Orange Bread and Butter Pudding

£19.95 + VAT per person

LOCATION & DIRECTIONS

Whether you are travelling by car or public transport, Franklin's Gardens is easily accessible from the entire country and beyond.

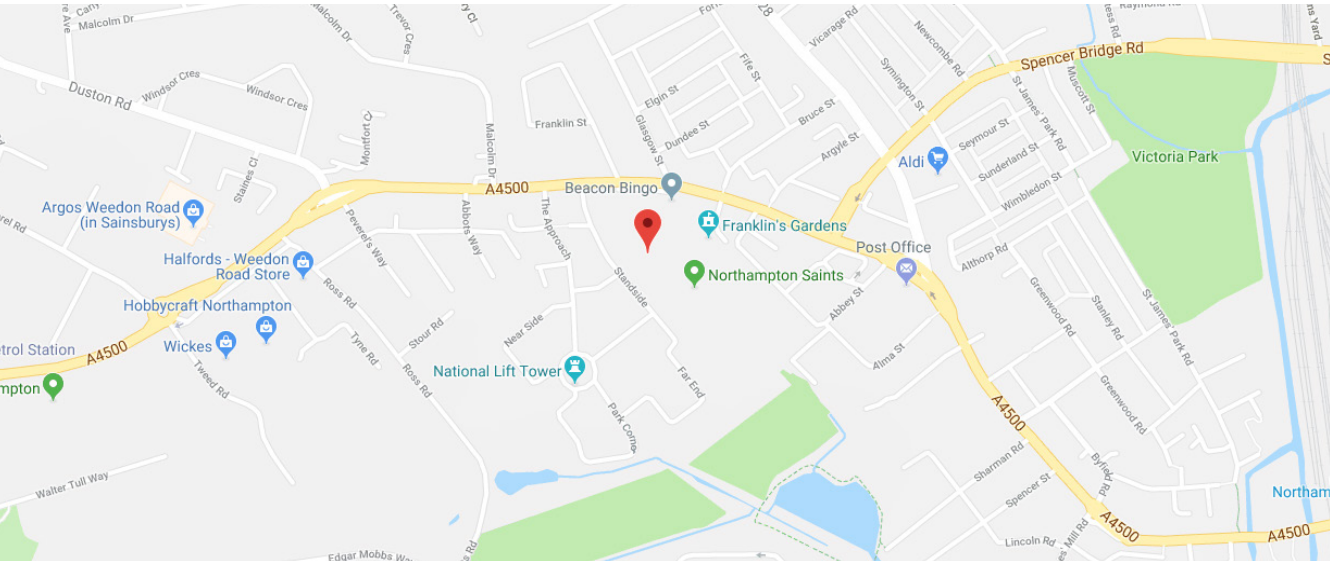

By Car

A five-minute drive from junctions 15A and 16 of the M1, Franklin's Gardens can be reached in around one hour's drive from London, Birmingham, Oxford and Cambridge.

By Rail

Northampton Station lies on the West Coast Main Line, with regular services to London and Birmingham. The station is approximately 15 minutes walk from Franklin's Gardens, with both taxis and buses readily available to take you door-to-door.

By Air

London Luton, Birmingham or Nottingham East Midlands airports, all within one hour's drive of Franklin's Gardens.

Car Parking

Franklin's Gardens has over 1,500 car parking spaces available on site.



01604 599 136
franklingardens@northhamptonsaints.co.uk